

Installation Instructions

Overhead Door Closer – Model DCF2003

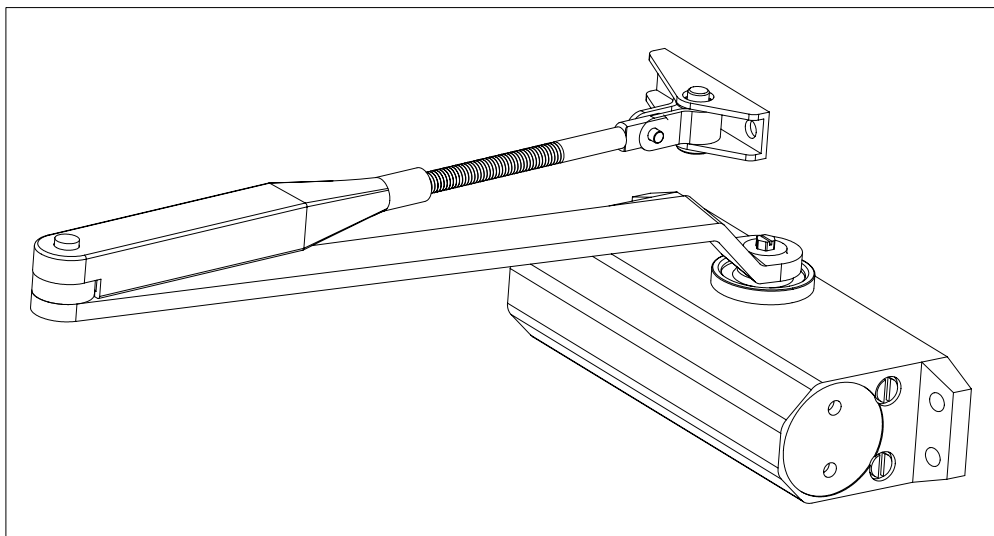

	Eurospect Architectural Hardware Ltd Stancliffe Street, Mill Hill Blackburn, BB2 2QR					
	1121 - CPD - AD0196					
	08					
EN 1154:1996 + A1:2002	4	8	3	1	1	3

IMPORTANT INFORMATION

Selecting the correct door closer to suit door size

Power Size	Max. Width of Door	Max. Mass of Door
2	850mm	40Kg
3*	950mm	60Kg
4	1100mm	80Kg
5	1250mm	100Kg
6	1400mm	120Kg

*Minimum size for use on fire doors



Important notes:

Minimum size 3 MUST be used on fire doors

Hold open arms must NOT be used on fire doors

This product is non handed and can be fitted on both left handed and right handed doors.

Maintenance

Check that the door closer closes the door correctly and adjust as necessary. Ensure fixing screws are tight and periodically apply light oil or grease to arm knuckle joint

Tel: +44 (0) 1254 274100

Fax: +44 (0) 1254 274111

Web: www.eurospec.co.uk

PLEASE LEAVE THESE INSTRUCTIONS WITH THE END USER

Fig 1 – Standard Application (Door closer fitted on pull face of door)

Illustrations show anti-clockwise closing door

1. Ensure that the door & surrounding frame are in good condition & the door closes freely.
2. Select the correct hand of Fig. 1 easi-fit template and with the door in the closed position, stick template to top corner of door and frame. (See **Figs. 1 & 2**)
3. Drill pilot holes in door and frame according to easi-fit template & securely fix door closer body with screws supplied. Ensure adjusting screws face hinge side of door. (See **Figs. 2 & 3**)
4. Carefully detach link arm from adjuster arm & securely fix adjuster arm shoe to frame ensuring the shoe is rotated in the correct position as shown on the template. (See **Fig. 4**)
5. Place link arm onto closer spindle at right angles to door, fit securing screw, move link arm and re-connect to adjuster arm. (See **Figs. 4 & 5**)



Note: To adjust arm to suit depth of frame, loosen nut, adjust arm & re-tighten nut.

6. Fit spindle cover cap to underside of closer. (See **Fig. 5**)
7. Check for correct closing & latching speeds and adjust if necessary. (See **Fig. 6**)

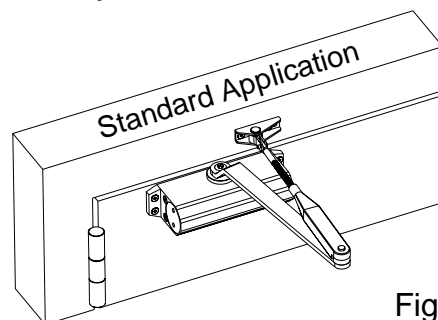

Fig. 1

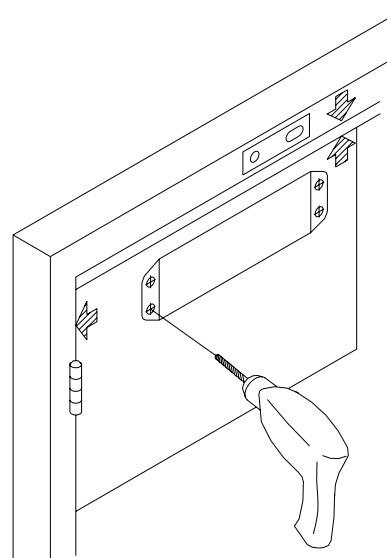

Fig. 2

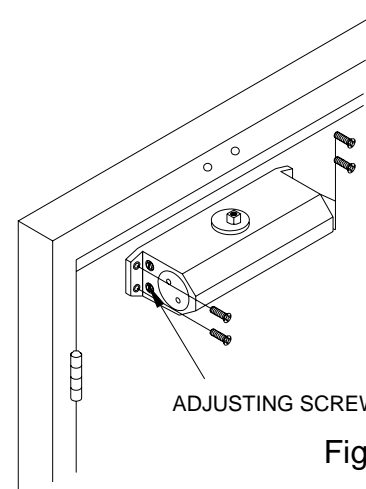

Fig. 3

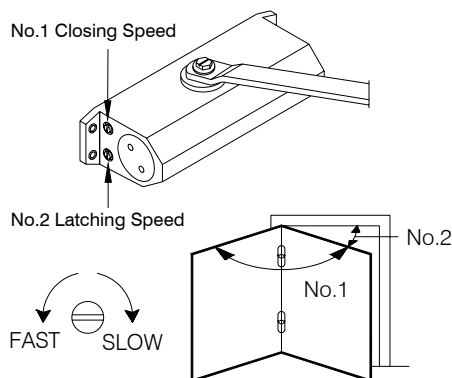

Fig. 6

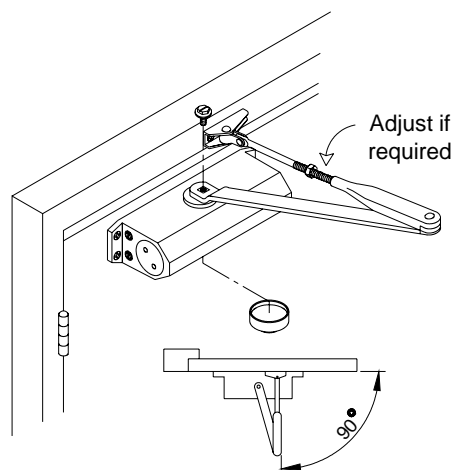

Fig. 5

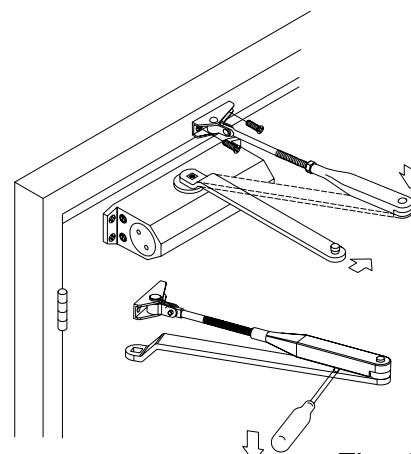



Fig. 4

Fig 66 – Parallel Arm Application (Door closer fitted on push face of door)

Illustrations show clockwise closing door

1. Ensure that the door & surrounding frame are in good condition & the door closes freely.
 2. Select the correct hand of Fig 66 easi-fit template and stick body of template to top corner of door. Fold and stick top of template to underside of frame. (See Figs. 1 & 2)
 3. Drill pilot holes in door and frame according to template & securely fix door closer body and Fig 66 bracket with screws supplied. Ensure adjusting screws face away from hinge side of door. (See Figs. 2 & 3).
 4. Carefully detach link arm from adjuster arm & securely fix adjuster arm shoe to fig.66 bracket ensuring the shoe is rotated in the correct position as shown on the template. (See Fig. 4)
 5. Place link arm onto closer spindle parallel to door, fit securing screw, move link arm and re-connect to adjuster arm. (See Figs. 4 & 5)
-  **Note:** Adjust arm length as required: Loosen nut, adjust arm & re-tighten nut.
6. Fit spindle cover cap to underside of closer. (See Fig. 5)
 7. Check for correct closing & latching speeds and adjust if necessary. (See Fig.6)

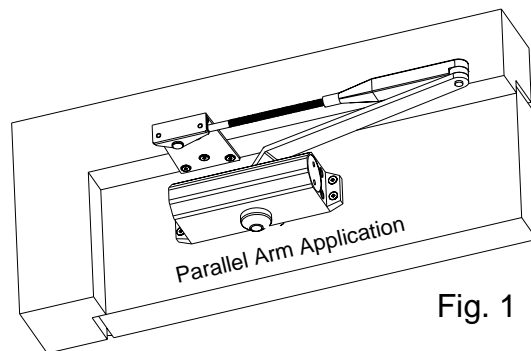

Fig. 1

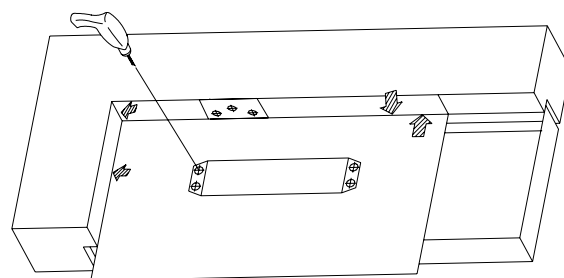

Fig. 2

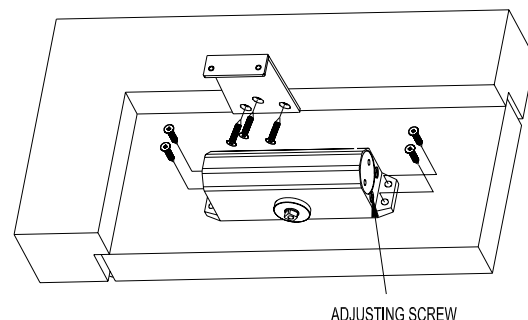

Fig. 3

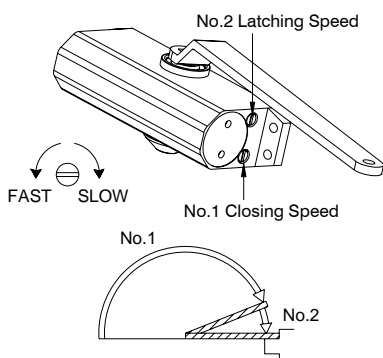

Fig. 6

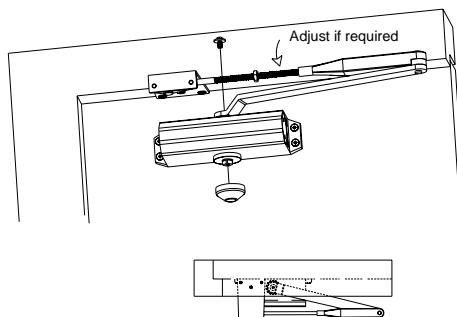

Fig. 5

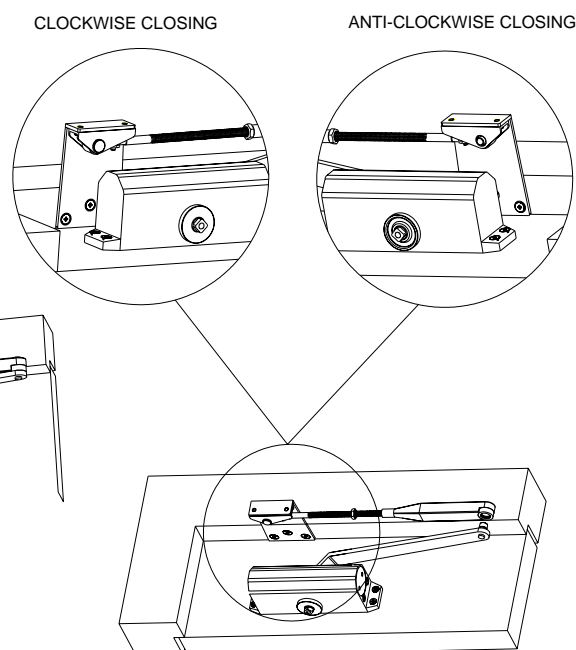

Fig. 4