



# MODEL DCEM2004 INSTALLATION INSTRUCTIONS

Size 4 Electromagnetic HO/FS Overhead Closer c/w Switch Box Cover

<b>DCEM2004</b> Size 4 EM HO/FS Closer with Switch Box Cover											
		Eurospec Architectural Hardware Ltd. Stancliffe Street, Mill Hill, Blackburn, BB2 2QR									
1121 - CPD - AE5001		04									
EN 1154:1996 + A1:2002 + AC:2006	3	8	<table border="1"> <tr> <td>4</td> <td>1</td> <td>1</td> <td>3</td> </tr> <tr> <td>3</td> <td></td> <td></td> <td></td> </tr> </table>	4	1	1	3	3			
4	1	1	3								
3											
EN 1155:1997 + A1:2002 + AC:2006	3	8	<table border="1"> <tr> <td>4</td> <td>1</td> <td>1</td> <td>3</td> </tr> <tr> <td>3</td> <td></td> <td></td> <td></td> </tr> </table>	4	1	1	3	3			
4	1	1	3								
3											

## ENDUROMAX

### IMPORTANT INFORMATION

SELECTING THE CORRECT DOOR CLOSER TO SUIT DOOR SIZE			
Limitations:	Power Size	Max. Width of Door	Max. Mass of Door
When fitted in Fig. 6 parallel arm application, this model is limited to maximum opening angle of 160°.	3*	950mm	60kg
	4	1100mm	80kg
* Minimum size for use on fire doors.			
POWER SOURCE REQUIREMENT			
24v DC 2 Watts 0.085 Amps	Power Supply Unit PSUA8/WHT must be used to ensure validity of mechanical warranty guarantee.		
This product is non handed and can be fitted on both left handed and right handed doors.			
PLEASE LEAVE THESE INSTRUCTIONS WITH THE END USER			

The Home of Quality Architectural Ironmongery

Tel: 01228 511030 Fax: 01228 511885 Web: [www.carlislebrass.com](http://www.carlislebrass.com)

## INSTALLATION - FIG 1 SWING FREE APPLICATION - ANGLE OF OPENING LIMITED TO 170°

**Fig 1 - Standard Swing Free Application (Door closer fitted on pull face of door)**

As per diagram, secure the swing free boss with one M5 allen screw into the threaded hole on the arm nearest to the hinge.

For alternative, Hold Open application, secure the hold open boss with the 2 larger M5 allen screws, ensuring they are tightly secured, as per diagram.

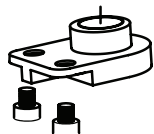

### **HOLD OPEN MODE**

Using the 2 longer M5 screws secure the hold open boss onto the arm, making sure they are tight

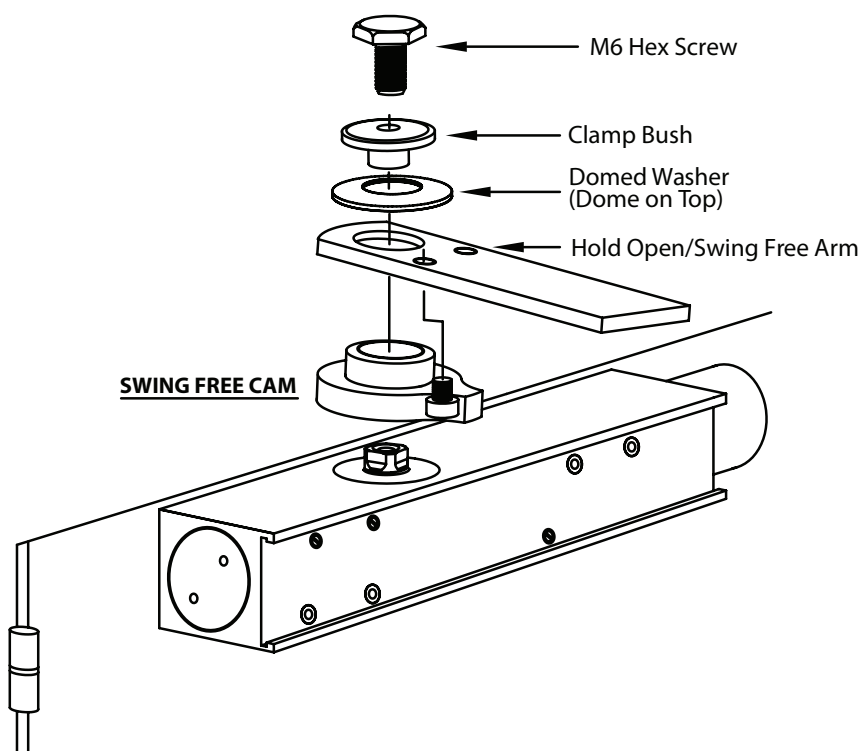
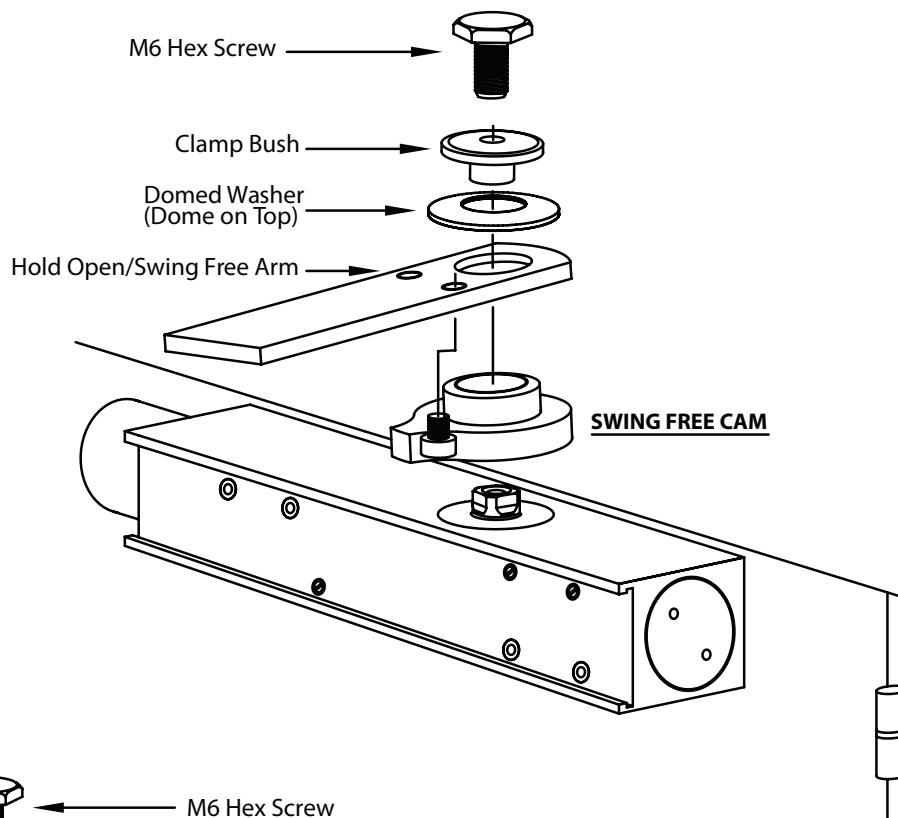

### **HOLD OPEN MODE**

Using the 2 longer M5 screws secure the hold open boss onto the arm, making sure they are tight

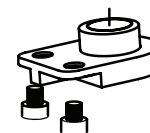

## CHECK CORRECT OPERATION

Ensure the switch on the junction box is in the on position before testing.

After switching on the 24vdc supply, open the door to the required position. The door will then operate as if there were no closer fitted. It may be opened or closed freely with no resistance.

In the event of the electric supply being interrupted, the door will close from whatever position it is in.

Failure to install this product as per these instructions and dimensions will negate guarantee.

## INSTALLATION - FIG 6 APPLICATION - ANGLE OF OPENING LIMITED TO 160°

### Fig 6 - Parallel Arm Application (Door closer fitted on push face of door)

As per diagram, secure the swing free boss with one M5 allen screw into the threaded hole on the arm furthest from the hinge.

For alternative, Hold Open application, secure the hold open boss with the 2 larger M5 allen screws, ensuring they are tightly secured, as per diagram.

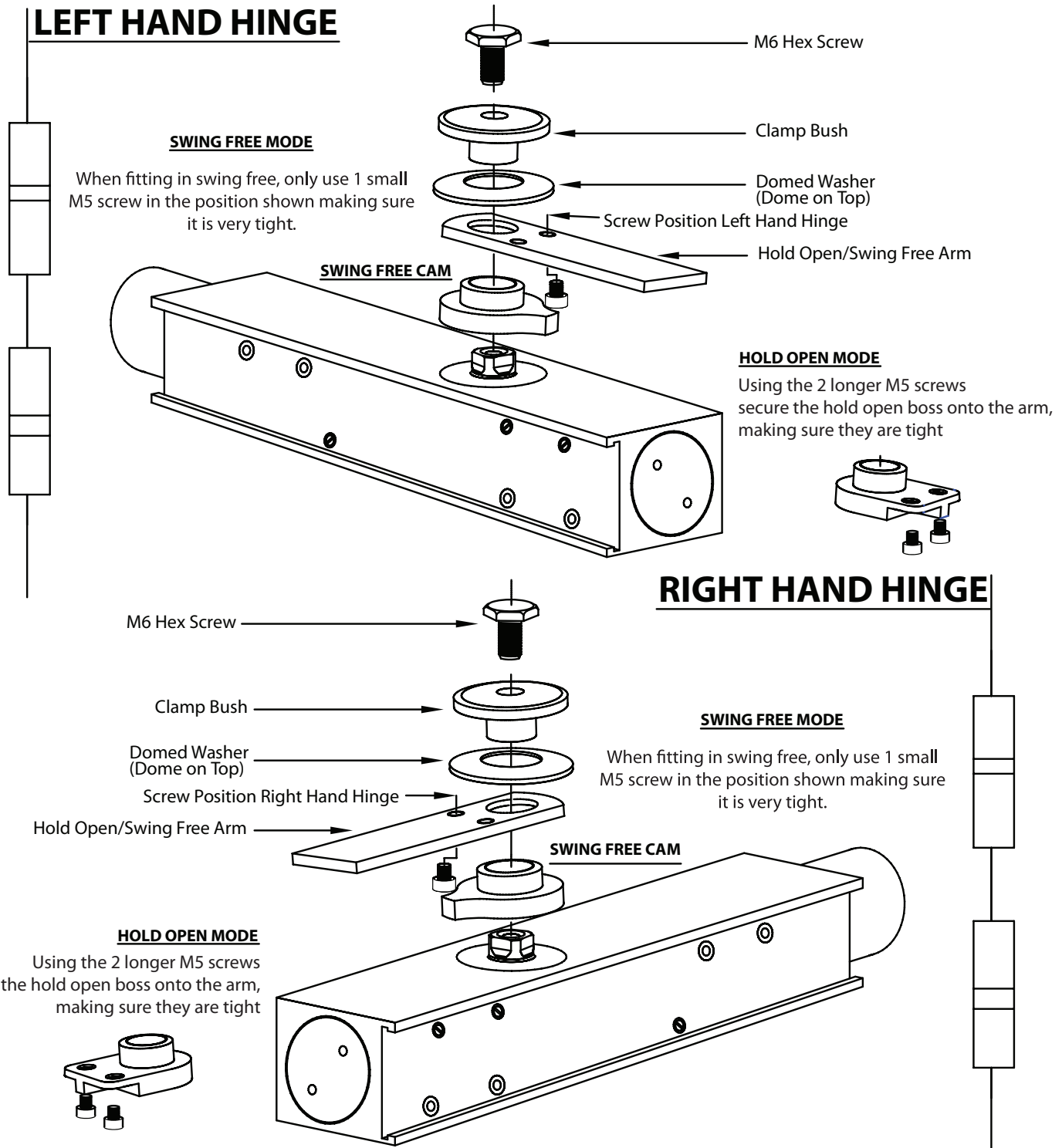

## CHECK CORRECT OPERATION

Ensure the switch on the junction box is in the on position before testing.

After switching on the 24vdc supply, open the door to the required position. The door will then operate as if there were no closer fitted. It may be opened or closed freely with no resistance.

In the event of the electric supply being interrupted, the door will close from whatever position it is in.

## PERIODIC MAINTENANCE SCHEDULE

1. Check that all instructions provided by the manufacturer are adhered to and that the door closer closes the door correctly.
2. Ensure that all fixing screws, including the connection of arm to body are tight.
3. Check the spring strength is set correctly and adjust if necessary.
4. Perform checks on any controls relating to delay, closing speed, latching action and back check, and adjust as required.
5. Lightly lubricate arm joints and rollers with light oil or grease.
6. Ensure that at all times, care and maintenance are carried out by competent personnel and that records are kept.
7. Use chart below as a guide to checking your doorset.

